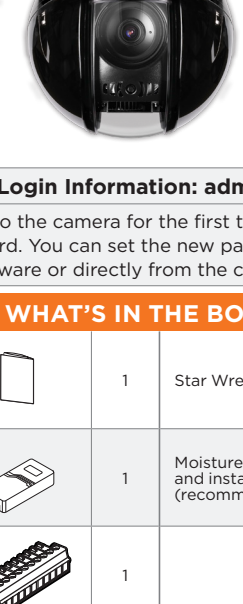

MEGAPIX®

IP Cameras

DWC-MPT2230XTW

Default Login Information: admin | admin

When logging into the camera for the first time, you must setup a new password. You can set the new password using the DW® IP Finder™ software or directly from the camera's browser menu.

WHAT'S IN THE BOX

Quick setup and download guides		1	Star Wrench (T-20)		1
PoE injector		1	Moisture absorber and installation guide (recommended)		1 set
Terminal block		1			

ACCESSORIES REQUIRED TO INSTALL THE CAMERA (SOLD SEPARATELY)

Wall mount bracket: DWC-P230WFW	Ceiling mount bracket: DWC-P230CMW	Flush mount: DWC-P230FMW	Parapet mount: DWC-PZPARAM
------------------------------------	---------------------------------------	-----------------------------	-------------------------------

NOTE: Mounting accessories are required and sold separately.

NOTE: Download all your support materials and tools in one place

- Go to: <http://www.digital-watchdog.com/resources>
- Search your product by entering the part number in the 'Search by Product' search bar. Results for applicable part numbers will populate automatically based on the part number you enter.
- Click 'Search'. All supported materials, including manuals and quick start guide (QSGs) will appear in the results.

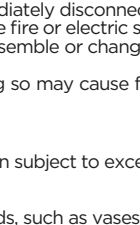
Attention: This document is intended to serve as a quick reference for the initial set-up. It is recommended that the user read the entire instruction manual for complete and proper installation and usage.

SAFETY AND WARNING INFORMATION

Read through this Installation Guide carefully before installing the product. Keep the Installation Guide for future reference. See the user manual for more information on the proper installation, use and care of the product. These instructions are intended to ensure that users can use the product correctly to avoid danger or property loss. Warnings: Serious injury or death may occur if any of the warnings are neglected. Cautions: Injury or equipment damage may occur if any of the cautions are neglected.

- WARNING**
- In the use of the product, you must be strict compliance with the electrical safety regulations of the nation and region. When the product is mounted on a wall or ceiling, the device shall be firmly fixed.
 - Be sure to use only the standard adapter specified in the specification sheet. Using any other adapter could cause fire, electrical shock, or damage to the product.
 - Make sure the power supply voltage is correct before using the camera.
 - Incorrectly connecting the power supply or replacing the battery may cause an explosion, fire, electric shock, or damage to the product.
 - Do not connect multiple cameras to the single adapter. Exceeding the capacity may cause excessive heat generation or fire.
 - If you place the power cord into the power source. An insecure connection may cause a fire.
 - When installing the camera, fasten it securely and firmly. A falling camera may cause personal injury.
 - Do not install in a location subject to elevated temperature, low temperature, or high humidity. Doing so may cause fire or electric shock.
 - Do not place conductive objects (e.g. screwdrivers, coins, metal items, etc.) or containers filled with water on top of the camera. Doing so may cause personal injury due to fire, electric shock, or falling objects.
 - Do not install in humid, dusty, or sooty locations. Doing so may cause fire or electric shock.
 - Do not install near any heat sources such as radiators, heat registers, or other products (including amplifiers)
 - Keep out of direct sunlight and heat radiation sources. It may cause a fire.
 - Do not use this product near water.
 - Properly plug the power cord into the power source. An insecure connection may cause a fire or electric shock.
 - Do not touch the camera's lens or sensor module with fingers. If cleaning is necessary, please use a clean cloth to wipe it gently. If the device will not be used for a long time, please cover the lens cap to protect the device from dirt.
 - When cleaning the product, do not spray water directly onto parts of the product. Doing so may cause fire or electric shock.

CAUTION

- Use proper safety gear when installing and wiring the product.
- Do not drop objects on the product or apply strong shock to it. Keep away from a location subject to excessive vibration or magnetic interference.
- Do not use this product near water.
- The product shall not be exposed to dripping or splashing and no objects filled with liquids, such as vases, shall be placed on the product.
- Avoid aiming the camera directly towards extremely bright objects such as the sun, as this may damage the image sensor.
- Always use hardware (e.g. screws, anchors, bolts, locking nuts, etc.) compatible with the mounting surface and of sufficient length and construction to ensure a secure mount.
- Use only with cart, stand, tripod, bracket, or table specified by the manufacturer, or sold with the product.
- Unplug this product when a cart is used. Use caution when moving the cart/product combination to avoid injury from tip-over.
- Refer all servicing to qualified service personnel. Servicing is needed when the product has been damaged in any way, such as power supply cord or plug is damaged, liquid has been spilled or objects have fallen into the product, the product has been exposed to rain or moisture, does not operate normally, or has been dropped.

STEP 1 – PREPARING TO MOUNT THE CAMERA

- The mounting surface must bear five times the weight of your camera.
- Avoid allowing cables to become pinched or abraded during installation. If the plastic wire jacket of the electrical line is damaged, it could result in an electrical short or fire.
- Before the installation, remove the lens protection cap and tape.
- CAUTION:** These servicing instructions are for use by qualified service personnel only. To reduce the risk of electric shock do not perform any servicing other than that contained in the operating instructions unless you are qualified to do so.
- Ensure that this product is supplied power by a UL Listed Power Supply Unit marked "Class 2" or "LPS" or "PS2" and rated 24 Vac, 1.46A min or 24 Vdc, 1.67A or PoE (802.3bt) 0.88A min.
- The wired LAN hub providing power over the Ethernet (PoE) in accordance with IEEE 802.3bt shall be a UL Listed device with the output evaluated as a Limited Power Source as defined in UL60950-1 or PS2 as defined in UL62368-1.
- Unit is intended for installation in a Network Environment 0 as defined in IEC TR 62102. As such, associated Ethernet wiring shall be limited to inside the building.
- Install the moisture packet in the base of the camera module.
 - Remove the moisture absorber from the packaging.
 - Place the moisture absorber under the camera's lens module as shown in the picture on the right.

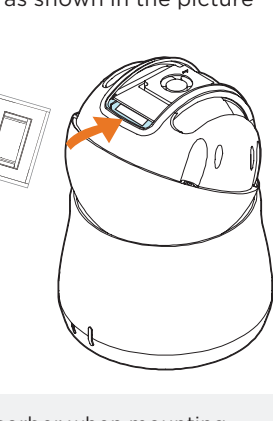

NOTE: The camera will generate enough heat to dry moisture during operation. In most cases it will not need the moisture absorber for more than the first day. In cases where the camera can experience a moisture issue, users must keep the moisture absorber in the camera. The moisture absorber has an approximately 6-month life cycle, varying depending on the environment.

WARNING: It is highly recommended that you install the moisture absorber when mounting the camera. The moisture absorber prevents moisture from being captured inside the camera's housing, which may cause image performance issues and damage the camera.

- The camera requires a mounting accessory, sold separately, to complete the installation. Using the accessory's mounting template, mark and drill the necessary holes in the mounting surface.

STEP 2 – POWERING THE CAMERA

Pass the wires through and make all necessary connections. See STEP 4 for more information.

- When using a PoE Switch or the PoE injector included with the camera, connect the camera using an Ethernet cable for both data and power.
- When not using a PoE Switch or the PoE injector included with the camera, connect the camera to the switch using an Ethernet cable for data transmission and use a power adapter to power the camera.

Power requirements	Power consumption
PoE IEEE 802.3bt class5 (PoE injector included), DC24V, AC24V	DC24V: 40W, 1666mA AC24V: 35W, 1485mA PoE: 42W, 1750mA

STEP 3 – INSTALLING THE CAMERA

- Install the mounting accessory (sold separately) to the mounting surface according to the installation guide.
- Pass wires through the mounting bracket.
- Connect the camera's base into the mounting accessory's neck, and secure using the screws on the side of the mounting accessory neck.
- Open the camera's base by rotating the base clockwise to the unlock position. Make sure the camera's safety wire is connected between the camera base and the camera module.

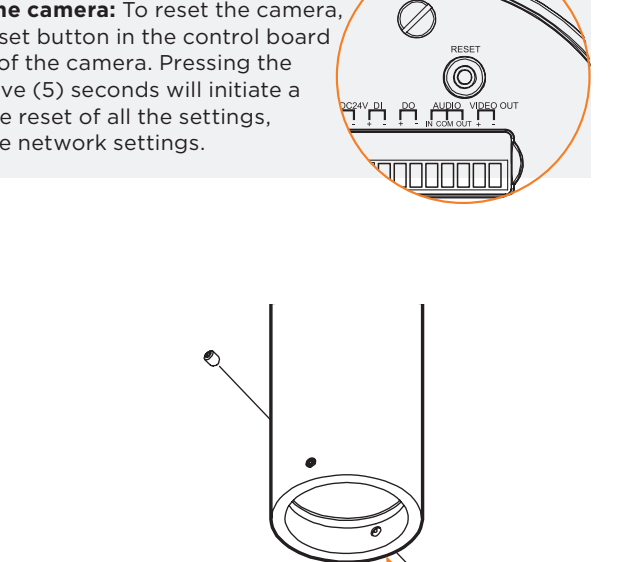

- Connect all wires to the camera. See STEP 2 and STEP 4 for more information.
- Attach the camera's body to the base and mounting accessory by rotating the base counter-clockwise to the lock position.
- Place the dome on the camera module by securing the screws at the base of the dome.
- Remove the protection film when the installation is complete.

Resetting the camera: To reset the camera, press the reset button in the control board at the base of the camera. Pressing the button for five (5) seconds will initiate a camera-wide reset of all the settings, including the network settings.

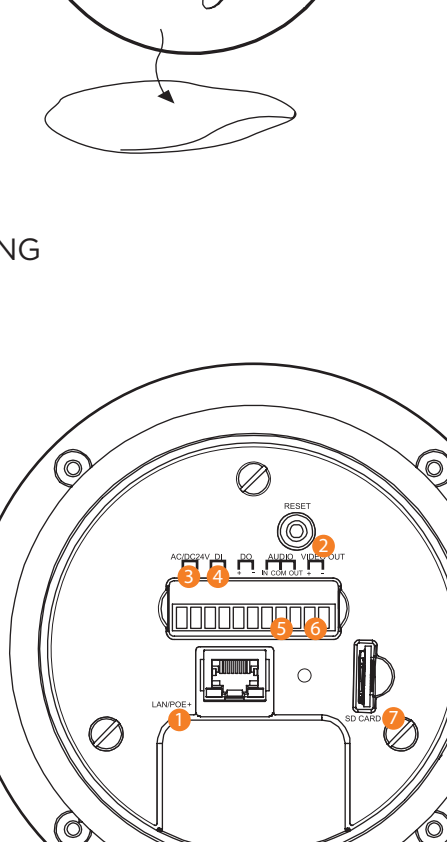
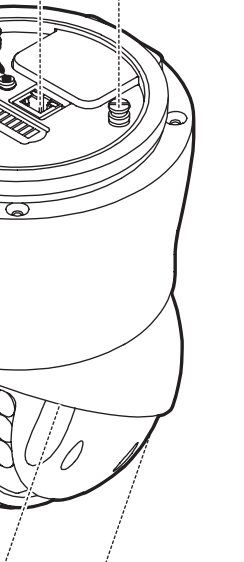
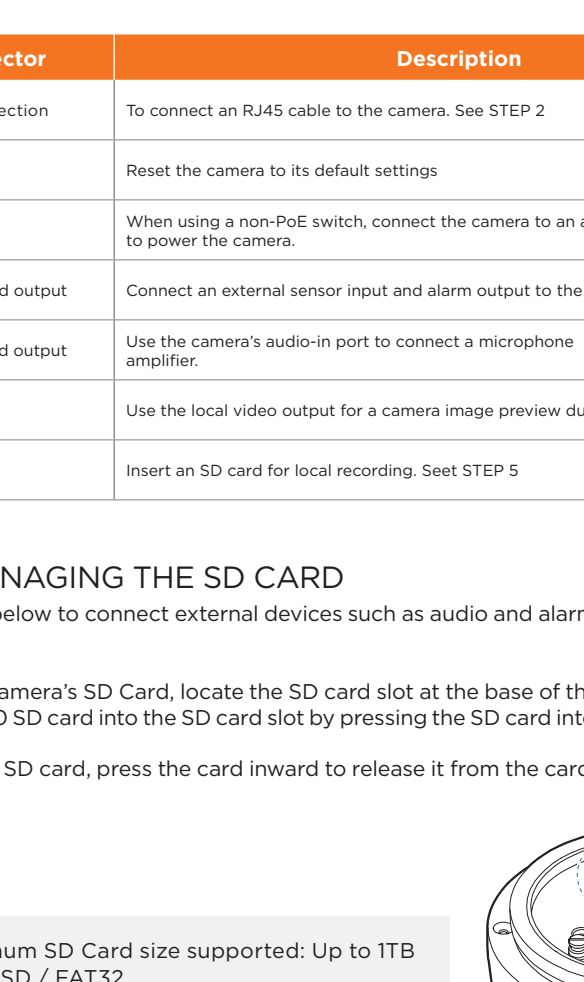
STEP 4 – CABLING

No.	Connector	Description
1	Network connection	To connect an RJ45 cable to the camera. See STEP 2
2	Reset button	Reset the camera to its default settings
3	Power	When using a non-PoE switch, connect the camera to an adequate power adapter to power the camera.
4	Alarm input and output	Connect an external sensor input and alarm output to the camera's terminal block.
5	Audio input and output	Use the camera's audio-in port to connect a microphone or "line out" port of an amplifier.
6	Video output	Use the local video output for a camera image preview during the installation.
7	SD card slot	Insert an SD card for local recording. See STEP 5

STEP 5 – MANAGING THE SD CARD

Use the diagram below to connect external devices such as audio and alarm inputs and outputs to the camera.

- To install the camera's SD Card, locate the SD card slot at the base of the camera.
- Insert a class 10 SD card into the SD card slot by pressing the SD card into the slot until it clicks into position.
- To remove the SD card, press the card inward to release it from the card slot.

NOTE: Maximum SD Card size supported: Up to 1TB micro SD / FAT32. When inserting the SD card into the card slot, the SD card's should be facing upward, as shown in the diagram.

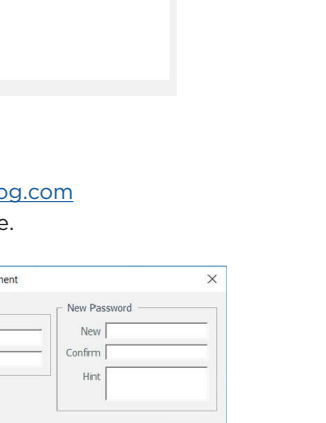
STEP 6 – DW® IP FINDER™

Use the DW IP Finder software to scan the network and detect all MEGAPIX® cameras, set the camera's network settings or access the camera's web client.

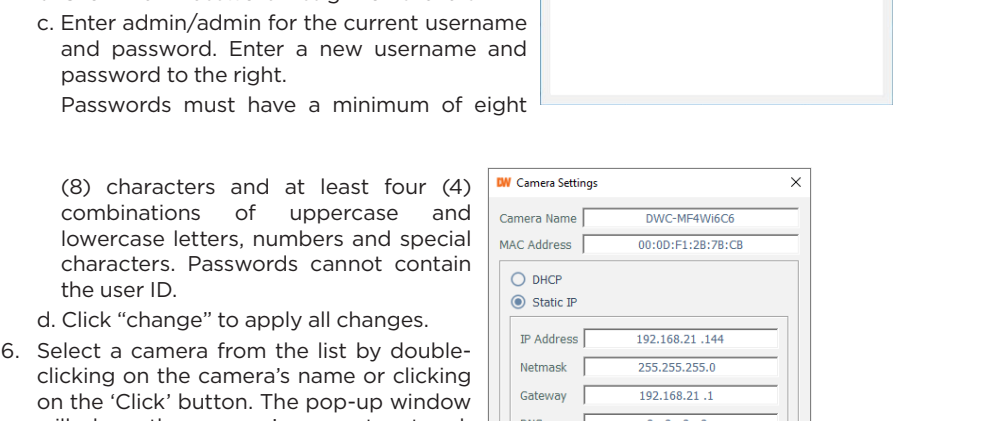

Network Setup

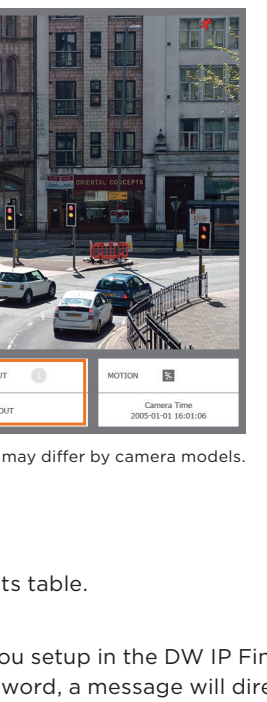
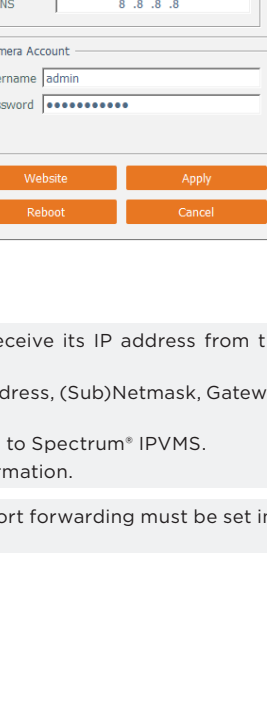
- To install the DW IP Finder, go to: <http://www.digital-watchdog.com>
- Enter "DW IP Finder" on the search box at the top of the page.
- Go to the "Software" tab on the DW IP Finder page to download and install the installation file.
- Open the DW IP Finder and click 'Scan Devices'. It will scan the selected network for all supported devices and list the results in the table. During the scan, the DW® logo will turn gray.
- When connecting to the camera for the first time, a password must be set.
 - Check the box next to the camera in the IP Finder's search results. You can select multiple cameras.
 - Click "Bulk Password Assign" on the left.
 - Enter admin/admin for the current username and password. Enter a new username and password to the right. Passwords must have a minimum of eight (8) characters and at least four (4) combinations of uppercase and lowercase letters, numbers and special characters. Passwords cannot contain the user ID.
 - Click "change" to apply all changes.
- Select a camera from the list by double-clicking on the camera's name or clicking on the 'Click' button. The pop-up window will show the camera's current network settings. Admin users can adjust the settings as needed. The camera's network settings are set to DHCP by default.
- To access the camera's web page, click on the 'Website' button.
- To save changes made to the camera's settings, enter the username and password of the camera's admin account and click 'Apply'.

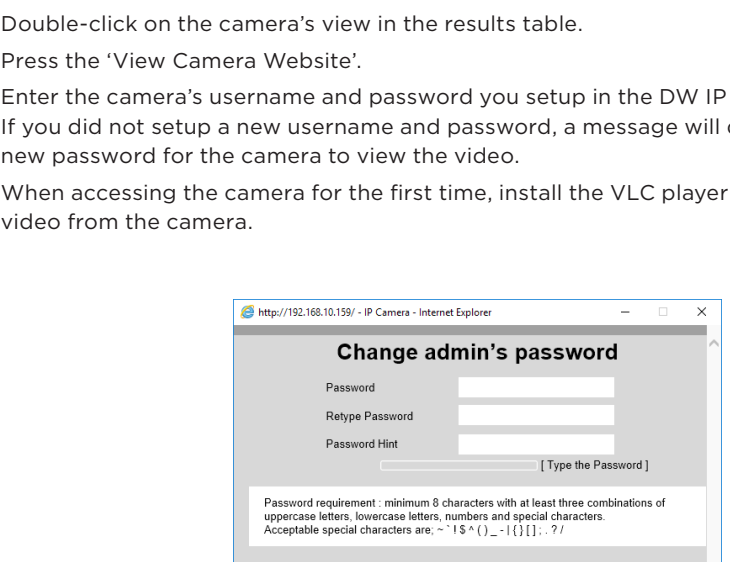

- Select 'DHCP' for the camera to automatically receive its IP address from the DHCP server.
- Select 'Static' to manually enter the camera's IP address, (Sub)Netmask, Gateway and DNS information.
- The camera's IP must be set to static if connecting to Spectrum® IPVMS.
- Contact your network administrator for more information.

To access the camera from an external network, port forwarding must be set in your network's router.

STEP 7 – WEB VIEWER

*The GUI display may differ by camera models.

- Find the camera using the DW IP Finder.
- Double-click on the camera's view in the results table.
- Press the 'View Camera Website'.
- Enter the camera's username and password you setup in the DW IP Finder. If you did not setup a new username and password, a message will direct you to setup a new password for the camera to view the video.
- When accessing the camera for the first time, install the VLC player for web files to view video from the camera.

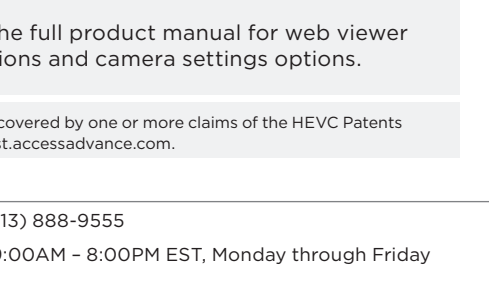

NOTE: Please see the full product manual for web viewer setup, functions and camera settings options.

